

B65206

ITEM NO.	PART NUMBER	DESCRIPTION	QTY.
1	01-0094	SCREW, SHS, 1/4-20 X .375, BLOX	1
2	01-0245-1	SCREW, SHC, #8-32 X .875, BLOX, PATCH	2
3	01-0748	SCREW, SHC, SS, 1/4-20 X 3.50	1
4	01-2080	SCREW, SHC, 3/8-16 X 1.25, BLOX	4
5	04-01-142	O-RING, BUNA, -142	1
6	04-01-152	O-RING, BUNA, -152	1
7	04-01-231	O-RING, BUNA, -231	1
8	04-01-338	O-RING, BUNA, #338	1
9	04-01-902	O-RING, BUNA, -902	4
10	04-31-142	BACKUP RING, PARBAK, BUNA, -142	1
11	04-31-231	BACKUP RING, PARBAK, BUNA, -231	1
12	65-0065	PLUP, PRESSURE, CC	4
13	65-0251L	BODY, 16C	1
14	65-0252L	TOP, 16C	1
15	65-0253	PISTON, 16C	1
16	65-0254	LOCKING NUT, 16C	1

NOTE:

1. MAX PRESSURE 1350 PSI HYD.
2. APPROX. RADIAL CLAMPING FORCE IS 14.03 X PRESSURE.
3. ITEMS IN HEX BALLOONS ARE INCLUDED IN STD. REPAIR KIT 65-20294.

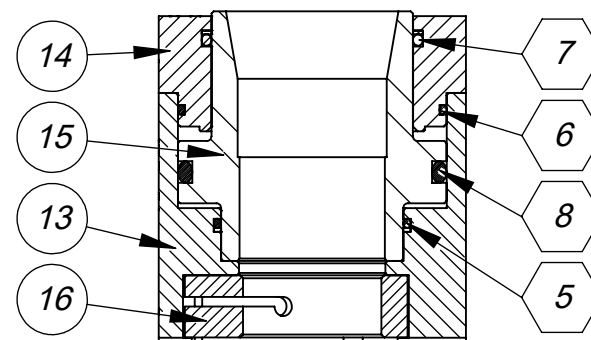
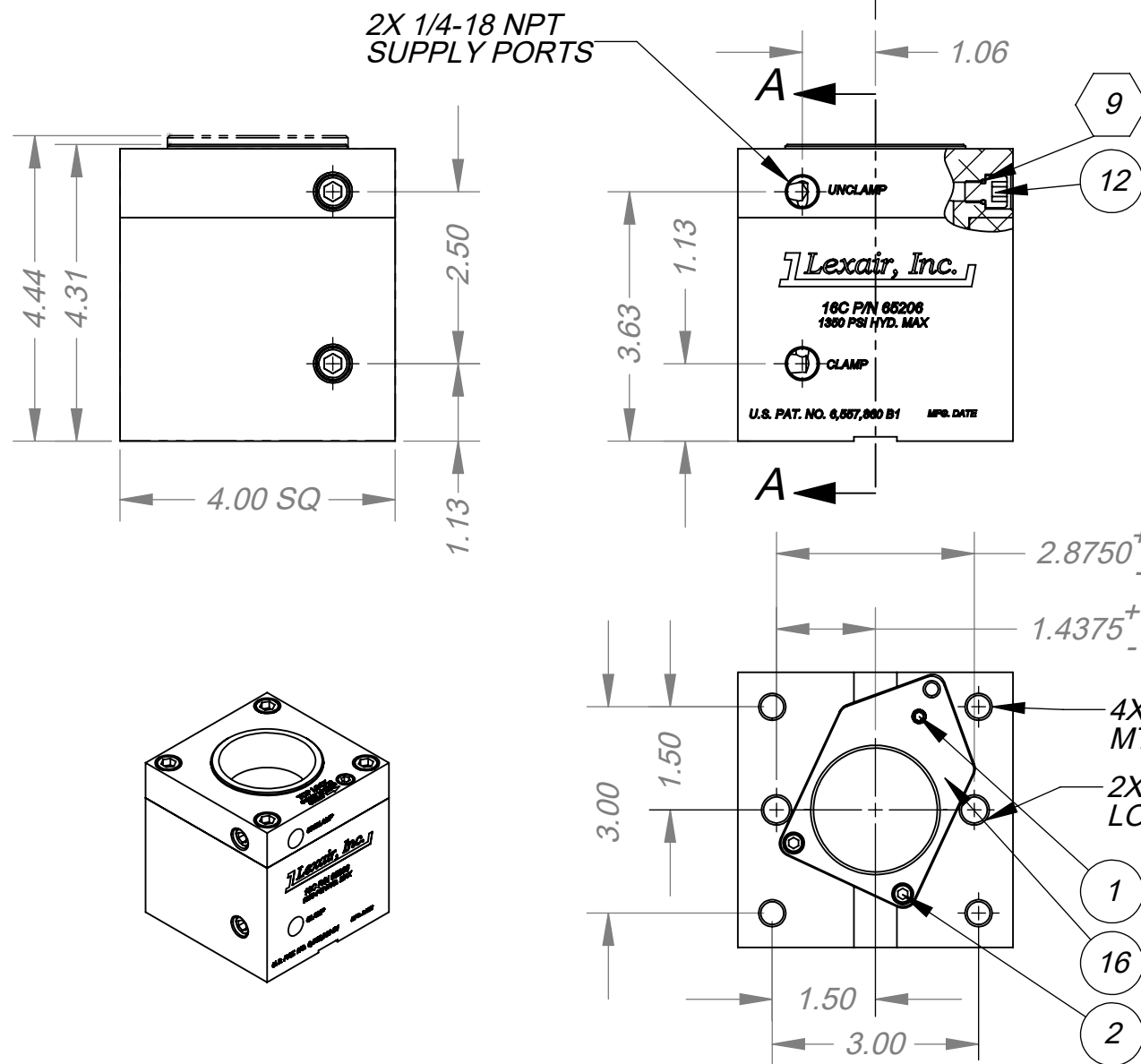

SECTION A-A
SCALE 1:2.5

THIS DOCUMENT AND ITS CONTENTS ARE THE PROPERTY OF LEXAIR, INC. THEY ARE FURNISHED TO YOU ON THE FOLLOWING CONDITIONS: NO RIGHT OR LICENSE IN RESPECT OF THIS DOCUMENT OR ITS CONTENTS IS GIVEN OR WAIVED IN SUPPLYING THE DOCUMENT TO YOU. THIS DOCUMENT OR ITS CONTENTS ARE NOT TO BE USED OR TREATED IN ANY MANNER INCONSISTENT WITH THE RIGHTS OF LEXAIR, INC. OR TO ITS DETRIMENT AND ARE NOT TO BE COPIED, REPRODUCED, OR DISCLOSED OF, EXCEPT WITH ITS PRIOR WRITTEN CONSENT.

REVISIONS

A	REDUCED PRESSURE RATING FROM 2000 TO 1350 ECL-17021
B	ECL-17047, 9-11-17, SMS: ADDED TOP LOCK LOGO

ECL: 07023 02-08-07 MJM

Tolerances Unless Otherwise Specified:		
TYPE	FINISHED	AS CAST
DEC .00	± .015"	± .030"
DEC .000	± .005"	± .010"
FRACTIONAL	± 1/64"	± 1/32"
ANGLES °	± 1/2°	± 1°

FINISH 175 μ in.

MATERIAL SPEC.

PROCESS SPEC.

PC. NO.: 65206

MADE FROM:

MODEL FILE: 65206.sldasm

CAD FILE: 65206.slddrw

CLOSER, COLLET 16C

16C DEAD LENGTH COLLET CLOSER TOP LOCKING, LEXAIR



2025 Mercer RD, Lexington, Kentucky 40511

DRAWN	CHECKED	APRVD.
MBR	MJM	TPO
02-08-07	02-08-07	02-08-07

B 65206

SHEET NO. 1 of 1

SHEETS

SCALE 1:2

APPROX. WT. 7.453 LBS