

B65106

THIS DOCUMENT AND ITS CONTENTS ARE THE PROPERTY OF LEXAIR, INC. THEY ARE FURNISHED TO YOU ON THE FOLLOWING CONDITIONS: NO RIGHT OR LICENSE IN RESPECT OF THIS DOCUMENT OR ITS CONTENTS IS GIVEN OR WAIVED IN SUPPLYING THE DOCUMENT TO YOU. THIS DOCUMENT OR ITS CONTENTS ARE NOT TO BE USED OR TREATED IN ANY MANNER INCONSISTENT WITH THE RIGHTS OF LEXAIR, INC. OR TO ITS DETRIMENT AND ARE NOT TO BE COPIED, REPRODUCED, OR DISCLOSED OF, EXCEPT WITH ITS PRIOR WRITTEN CONSENT.

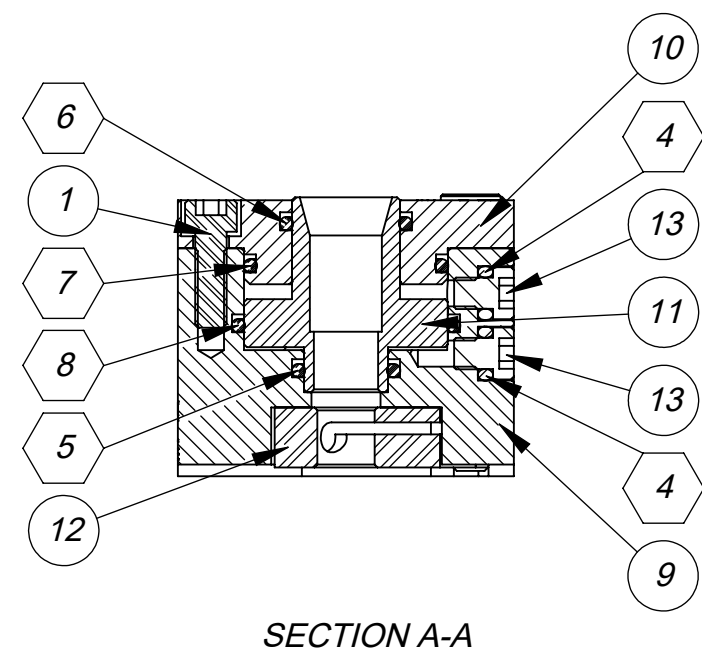
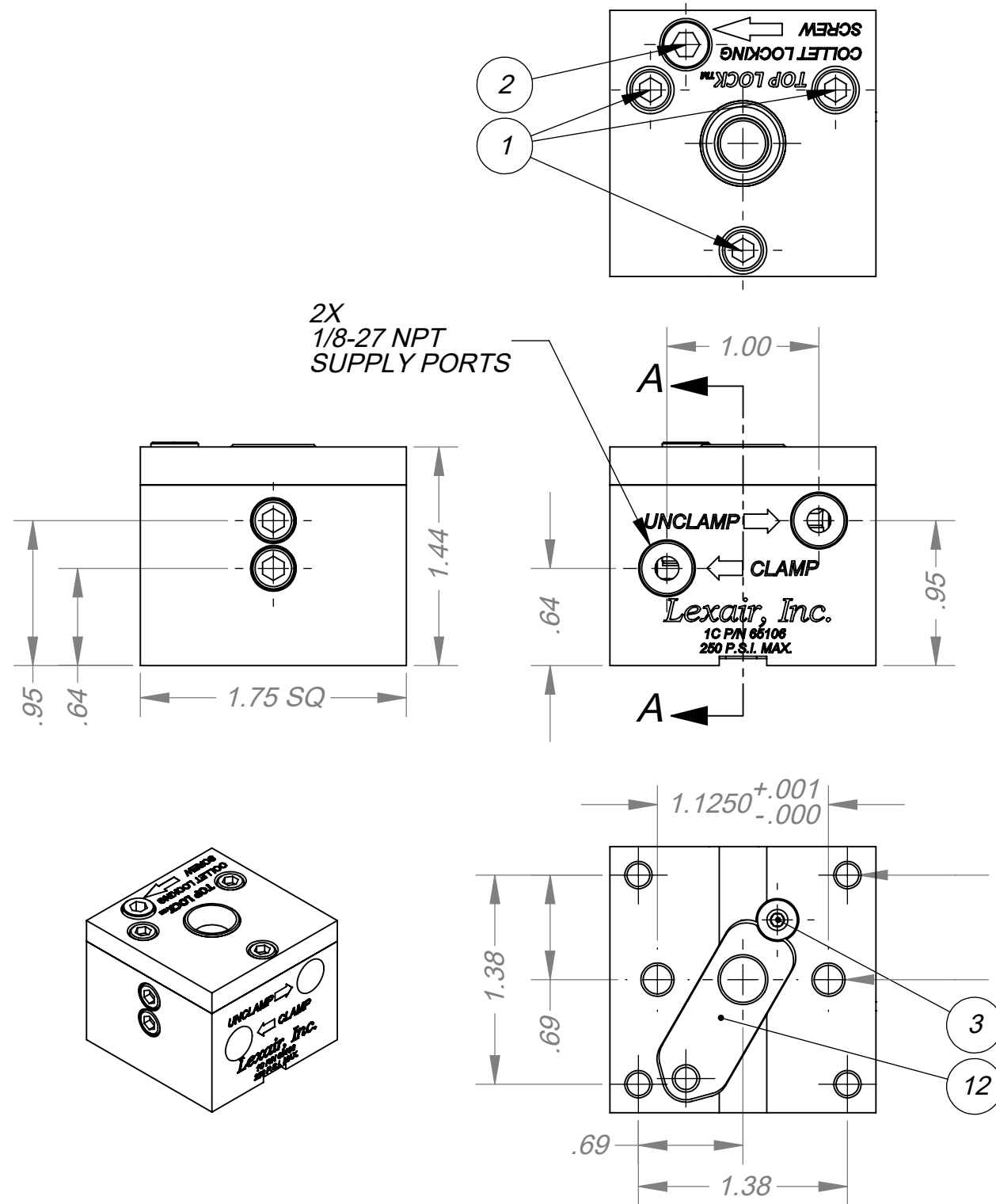

ITEM NO.	PART NUMBER	DESCRIPTION	QTY.
1	01-0003	SCREW, SHC, #8-32X.50, BLOX	3
2	01-0014	SCR., SHC 10-24 X 1.25 BLOX	1
3	01-2257	SCREW, BHC, #6-32X.25, BLOX	1
4	04-01-007	O-RING, BUNA, -007	6
5	04-01-013	O-RING, BUNA, #013	1
6	04-01-015	O-RING, #015 BUNA	1
7	04-01-021	O-RING, #021	1
8	04-01-023	O-RING, BUNA, #023	1
9	65-0245	BODY 1C COLLET CLOSER ANODIZED AND LASER ENGRAVED	1
10	65-0246	TOP, 1C, ANOD, LEXIAR LOGO	1
11	65-0247	PISTON, 1C	1
12	65-0248	NUT, COLLET LOCKING, 1C	1
13	65-0249	PLUG, PRESSURE, 1C	6

NOTES:

1. MAX PRESSURE 250 PSI.
2. APPROXIMATE RADIAL GRIP FORCE IS 1.57 x PRESSURE.
3. ITEMS SHOWN IN HEX BALLOONS ARE INCLUDED IN THE STD REPAIR KIT 65-0293.

REVISIONS

A ECL-17047, 9-11-17, SMS:
ADDED TOP LOCK LOGO

ECL: 07023 02/08/07 MJM

Tolerances Unless Otherwise Specified:		
TYPE	FINISHED	AS CAST
DEC .00	± .015"	± .030"
DEC .000	± .005"	± .010"
FRACTIONAL	± 1/64"	± 1/32"
ANGLES °	± 1/2°	± 1°
FINISH 175 μ in.		

MATERIAL SPEC.

PROCESS SPEC.

PC. NO.: 65106

MADE FROM:

MODEL FILE: 65106.sldasm

CAD FILE: 65106.slddrw

CLOSER, COLLET, 1C ASS'Y

1C DEAD LENGTH COLLET CLOSER, TOP LOCKING



2025 Mercer RD, Lexington, Kentucky 40511

DRAWN	CHECKED	APRVD.
MBR	MJM	TPO
02-08-07	02-08-07	02-08-07

B 65106

SHEET NO. 1 of 1

SHEETS

SCALE 1:1

APPROX. WT. 0.479 LBS.